

Peter Zenni

From: Peter Zenni
Sent: Tuesday, 7 February 2023 3:39 PM
To: 'beth.fowler@dplh.wa.gov.au'
Cc: Helen Croke
Subject: FW: Request for Lease over Lot 26740 on Deposited Plan 158701
Attachments: 20221121 Aerial - Lot 26740 on Deposited Plan 158701.pdf; 20221121 Tenure Map - Lot 26740 on Deposited Plan 158701.pdf; 20221121 Deposited Plan 158701.pdf

Hi Beth

Following on from our telephone conversation held earlier today, I confirm that the matter will have to be referred to the Shire of Merredin Council for its consideration before providing you with a formal response on behalf of the Shire of Merredin.

I note that in your conversation you referenced previous, historical advice provided by the Shire of Merredin with respect to this matter. Would you be kind enough to supply me with this information so that we can ensure that it is captured in our records system

Kind regards

Peter Zenni
EXECUTIVE MANAGER DEVELOPMENT SERVICES



Shire of Merredin
PO Box 42 MERREDIN WA 6415

P: (08) 9041 1611 F: (08) 9041 2379 E: emds@merredin.wa.gov.au
W: www.merredin.wa.gov.au  shireofmerredin

From: Beth Fowler <beth.fowler@dplh.wa.gov.au>
Sent: Tuesday, 7 February 2023 1:47 PM
To: Admin Officer <admin@merredin.wa.gov.au>
Subject: Request for Lease over Lot 26740 on Deposited Plan 158701

Case **2202732** File **02007-1936**

Dear Madam/Sir

REQUEST FOR LEASE OVER LOT 26740 ON DEPOSITED PLAN 158701

Please be advised that the Department of Planning, Lands and Heritage is considering a request for a new lease over Lot 26740 on Deposited Plan 158701 - CLT 3123-376.

Holcim (Australia) Pty Ltd currently hold Lease I786960 over Lot 26740 on DP 158701.

Holcim (Australia) Pty Ltd submitted a request to the Department of Planning, Lands and Heritage (then Department of Lands and Regional Development), on 20 May 2013, to exercise the option of a further ten (10) year lease term, extending the expiration date to 30 September 2023. No 'further term' is comprised within Lease I786960 and the current lease term will expire midnight 30 September 2023.

Holcim has advised the DPLH it requires a new lease for a five (5) year term commencing 1 October 2023 for the Permitted Use 'Concrete Batching Plant.'

Could the Shire of Merredin please provide their comments on the request for a new lease of Lot 26740 on DP 158701 for a term of five (5) years with the permitted use of 'Concrete Batching Plant.'

Please find attached:

- a) Aerial Map
- b) Tenure Map
- c) Deposited Plan

If you require further information, please do not hesitate to contact me.

Yours sincerely

Beth Fowler

State Land Officer | Land Use Management

Department of Planning, Lands and Heritage

140 William Street, Perth WA 6000

6551 9231 | wa.gov.au/dplh



The Department is responsible for planning and managing land and heritage for all Western Australians – now and into the future

The Department acknowledges the Aboriginal people of Western Australia as the traditional custodians of this land, and we pay our respects to their Elders, past and present.

Disclaimer: this email and any attachments are confidential and may be legally privileged. If you are not the intended recipient, any use, disclosure, distribution or copying of this material is strictly prohibited. If you have received this email in error, please notify the sender immediately by replying to this email, then delete both emails from your system.

This email and any attachments to it are also subject to copyright and any unauthorised reproduction, adaptation or transmission is prohibited.

There is no warranty that this email is error or virus free.

This notice should not be removed.



Legend

- Cadastral (View 1)
- Easements and Other Interests
- Roads**
 - Minor
 - Track
 - Not Applicable
- Land Tenure Small Scale 256K**
 - Crown Allotment (Type 2)
 - Lot on Survey (Type 1)
 - Reserve
- Land Tenure Small Scale 64K**
 - Crown Allotment (Type 2)
 - Lot on Survey (Type 1)
 - Public Road
 - Unallocated Crown Land
 - Lease
 - Reserve
 - Easement
- Land Tenure Small Scale 16K**
 - Crown Allotment (Type 2)
 - Lot on Survey (Type 1)
 - Public Road
 - Reserve
- Land Tenure Small Scale 4K**
 - Crown Allotment (Type 2)
 - Public Road

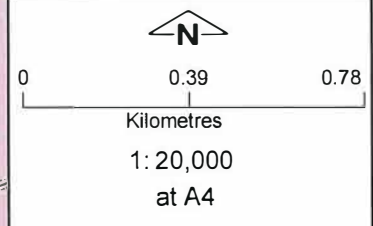

Notes:

- * The data that appears on the map may be out of date, not intended to be used at the scale displayed, or subject to license agreements. The map should only be used in matters related to Department of Planning, Lands and Heritage business.
- * This map is not intended to be used for measurement purposes.

Map was produced using DPLH's InQuery.

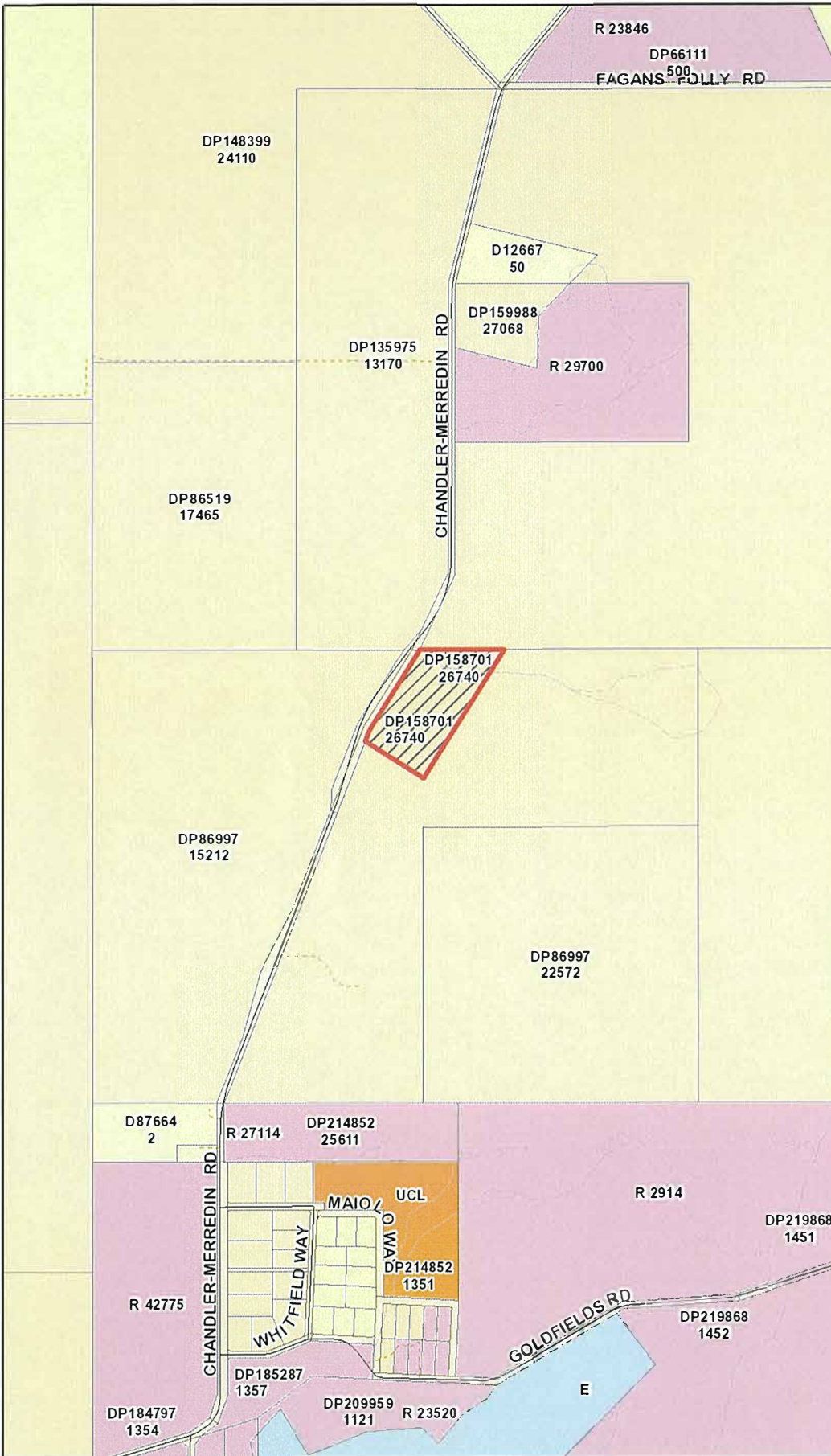

Lot 26740 on Deposited Plan 158701 (Lease - I786960)

DPLH BUSINESS USE ONLY

Internal Spatial Viewer
Projection: WGS_1984_Web_Mercator_Auxiliary_Sphere
Graticules (if visible): GDA 1994 Latitude/Longitude

Date produced: 21-Nov-2022

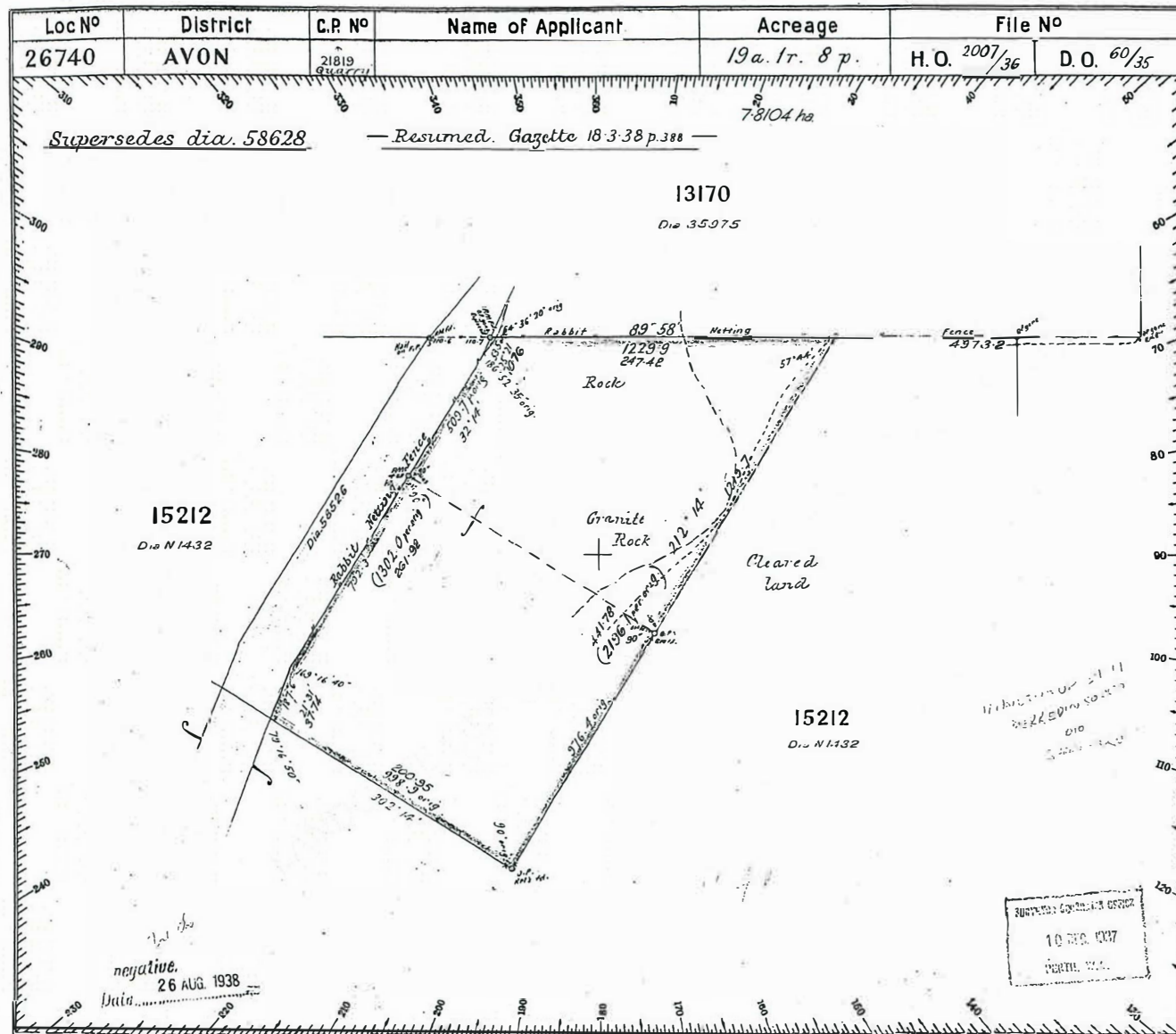

Azimuth observed at _____
 Or assumed from Road boundary
 Date of marking 10/11/1937
 Field Book No. 331 Page 3
 Scale 3 chains to an inch
 Public Plan No. 24/80 Division A.1

REFERENCE TO TREES.				
Corner.	Bearing.	Distance in Links	No. of Marks on Tree	Description of Tree.
A				
B				
C				
D				
E				
F				

SURVEYOR'S CERTIFICATE.

I hereby certify that this Survey was performed by me personally, for under my own personal supervision, inspection and field check) in strict accordance with the Regulations for the Guidance of Surveyors, and that this plan is in all respects accurate.

Hawthorn
 Date 10.12.37 Licensed Surveyor.

OFFICE REFERENCE.

Account No. 1/37 Passed 24/12/37
 Calculation Book No. 21 Fol. ii
 Chainage close Neat F-0.2
 Angular close +0.5"
 Area 13.22726
 Compared with F.B. 10/12/37
 Examined 23/12/37
 Diagram passed 23/12/37

Date 21/3/38
 Examiner of Plans

Survey approved _____
 Date 21/3/38
 Surveyor General.

On D.O. Public Plan _____
 On Standard Plan J.P. 21.3.38
 On Public Plan J.P. 21.3.38
 On Completion 1090-1093 J.P. 13.4.38

DIAGRAM No. 58701

Registered _____

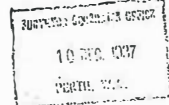



Legend

Cadastre (View 1)

Roads

— Minor

— Track

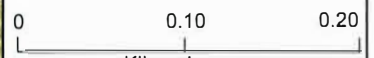

Kilometres

1: 5,000

at A4

Notes:

* The data that appears on the map may be out of date, not intended to be used at the scale displayed, or subject to license agreements. The map should only be used in matters related to Department of Planning, Lands and Heritage business.

* This map is not intended to be used for measurement purposes.

Map was produced using DPLH's InQuery.

Lot 26740 on Deposited Plan 158701 (Lease - I786960)

DPLH BUSINESS USE ONLY

Internal Spatial Viewer
Projection: WGS_1984_Web_Mercator_Auxiliary_Sphere
Graticules (if visible): GDA 1994 Latitude/Longitude

Date produced: 21-Nov-2022